

Hullin' it together!

Victoria Dock Walk



Victoria Dock Walk

Click on the markers to learn about your location

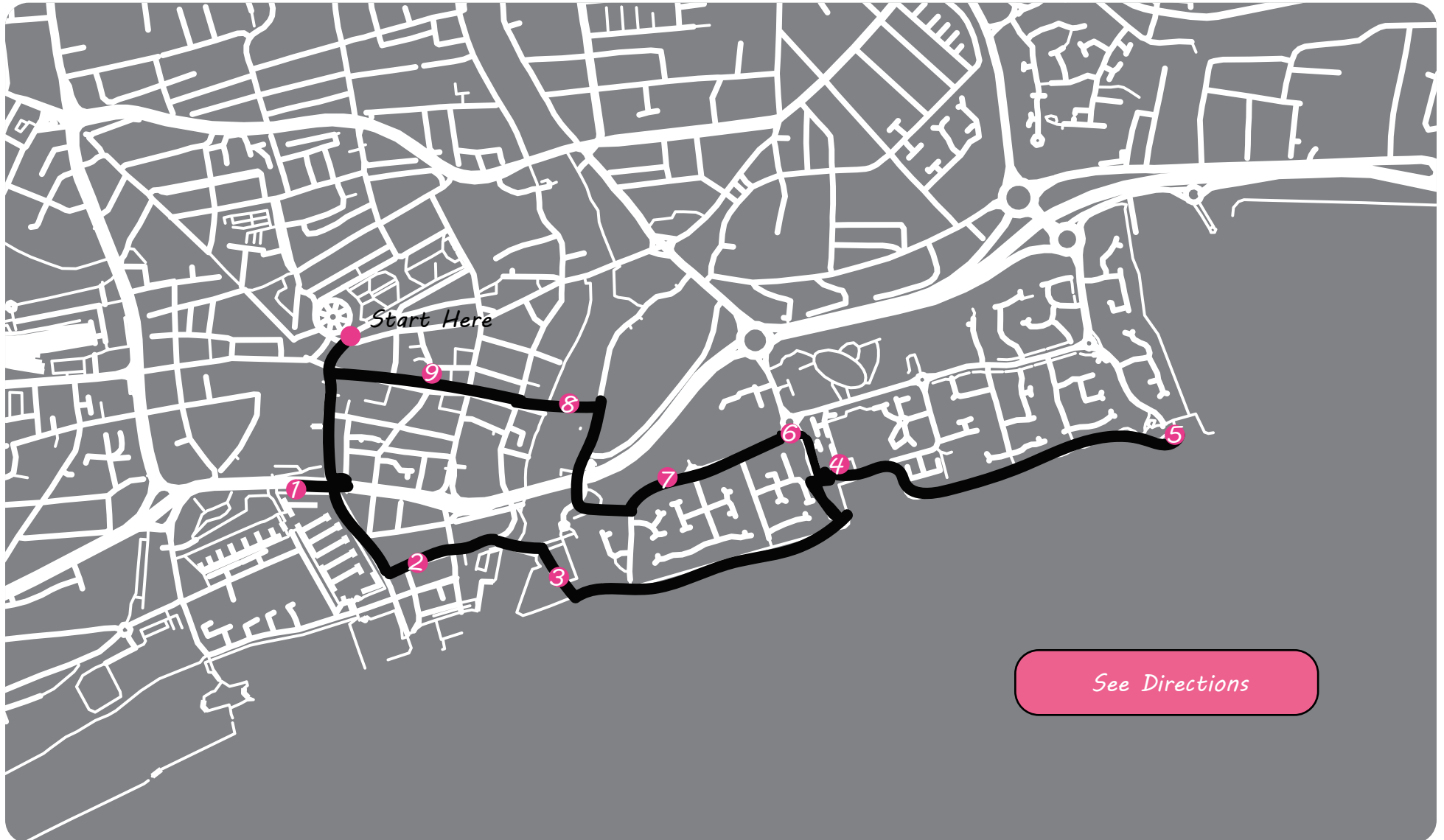

1 The walk starts at The Rosebowl. To start the walk, stand facing the fountain with The Warren behind you and start walking right towards and beyond Princes Quay. Continue down Princes Dock Street and on the right you will find the Murdoch Connection Footbridge, our next point.

2 Make your way across the bridge. There are ramps to the right of the bridge for those who may find stairs difficult. Turn left and then immediately right, following the rail around the marina. Make sure you take a moment to check out some of the boats. Turn left onto our next point, Humber Street.

3 At the end of Humber Street, cross the road and head between the Arco building and C4DI towards the Millennium Bridge and the tidal barrier. You will see The Deep across the bridge, our next point!

4 Head towards the grey reef shark statue by The Deep's entrance. Turn left and walk along the straight path parallel to the waters edge until you reach our next point, Victoria Dock.

5 Walk over the lock and continue down the waterfront to the Victoria Dock Viewing Point.

6 Head back the way you came until you reach Plimsole Way and right to view the pond reed bed.

7 Continue up Plimsoll Way, walking away from the Estuary. The Citadel Wall is across the road to your left.

8 Turn left onto South Bridge road, go straight over the roundabout and walk a little further up the road. Victoria Dock Play Park is situated on your right.

9 Continue walking on South Bridge Road and turn right onto Tower Street. You will come across Tower Street Car Park on your left. Enter the footpath and continue to walk over the Scale Lane Swing Bridge.

10 Walk off the bridge and up Scale Lane, taking in the beautiful historic buildings. Scale Lane turns into Sliver Street, which turns into Whitefriargate. Turn right at the top, bringing you back to the Rose Bowl Fountains, situated on your right.

[Back to Map](#)

Distance 7km

Time taken to walk 1hr 30 mins

Accessibility rating: Easy 

Please note : walk contains cobbled paths

Murdoch Connection Footbridge

Opening in 2021, the Murdoch Connection was named after Hull's first female GP, Mary Murdoch. It was named by students from Newland School for Girls. The bridge links Hull City Centre to the Marina. From its lowest point it stands 47 metres tall, which is 2 metres taller than Hull Minster. It weighs 150 tonnes and is 60 metre long.

Be sure to look out for the plaque about Mary Murdoch, it is situated by the ramp, so if you use the stairs you might miss it.

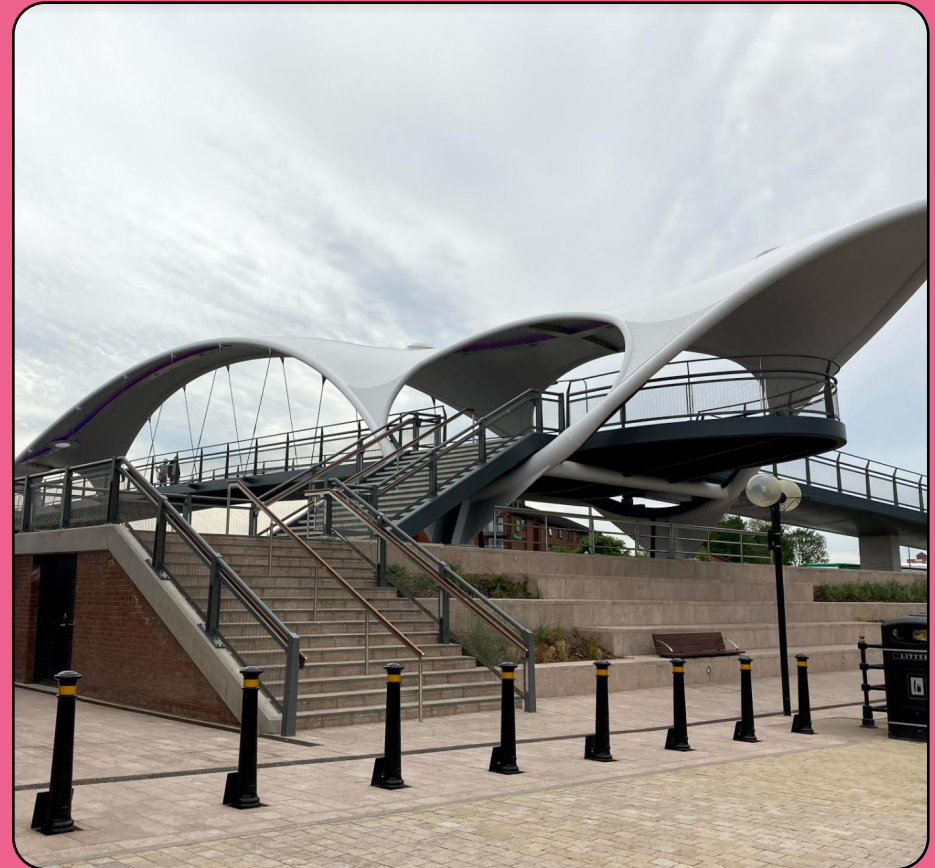

[Back To Map](#)



Humber Street

Humber Street has been a market street since the 16th century but the fruit trade didn't take off until the 19th century. It's location next to the water meant that merchants could sell fruit in the same place they delivered it. Now it is home to restaurants, bars, galleries and independent businesses but still stays true to its roots with a monthly market.



[Back To Map](#)



The Deep

The Deep opened in March 2002 and the worlds only submarium with over 3000 inhabitants. It has sharks, rays, penguins, turtles, frogs and of course fish! The main tank is 10 metres deep and has a glass lift running through it.



[Back To Map](#)



Victoria Dock

In the early 20th century Hull was Britain's first port with over 7 miles of docks along its Humber waterfront. Many of these are no longer in existence and have been replaced with modern developments. Victoria Dock opened in 1850 and closed in 1970. It was the first dock to be built on the east side of the River Hull. Although the area is now a housing estate you can still see the mechanisms of the lock opening system to this day.



[Back To Map](#)



Victoria Dock Viewing Point

Take a seat on the keyworkers memorial bench and look out at the Humber Estuary. The estuary drains water from the River Ouse and the River Trent out into the North Sea at Spurn Point.

The Siemens factory to your left produces wind turbines up to 75 metres long. With no seams, adhesives or connections, they are the worlds largest fibreglass components cast in one single piece.



Back To Map



Pond Reed Bed

When this was a working dock and ships needed repairing, they were often hauled up this slipway to get them onto dry land. The building at the top of the pond housed the engine and winch mechanism to pull boats out of the Humber.



Back To Map



Citadel Wall

The Citadel Wall is registered as a Scheduled Monument by Historic England. Hull's Citadel is an example of a very rare, self contained fort, used to house guns and protect the gunners from ammunition and attack. Only 25 of these sites were constructed nationally between 1660 and 1865. Of these, Hulls Citadel, Plymouth Citadel, Tilbury Fort and Clifford's Fort are the earliest examples, all dating from the late 17th century.



Back To Map



Victoria Dock Park Play

Have energy to burn? Or need a break? Take a moment to have some down time at Victoria Dock Play Park.



Back To Map



Scale Lane Swing Bridge

The Scale Lane Swing Bridge opened in 2013. Its design uniquely allows people to ride on the bridge whilst it rotates, a WORLD'S first! It's black steel appearance reflects Hull's industrial and maritime heritage, spanning 57 meters.



[Back To Map](#)

